

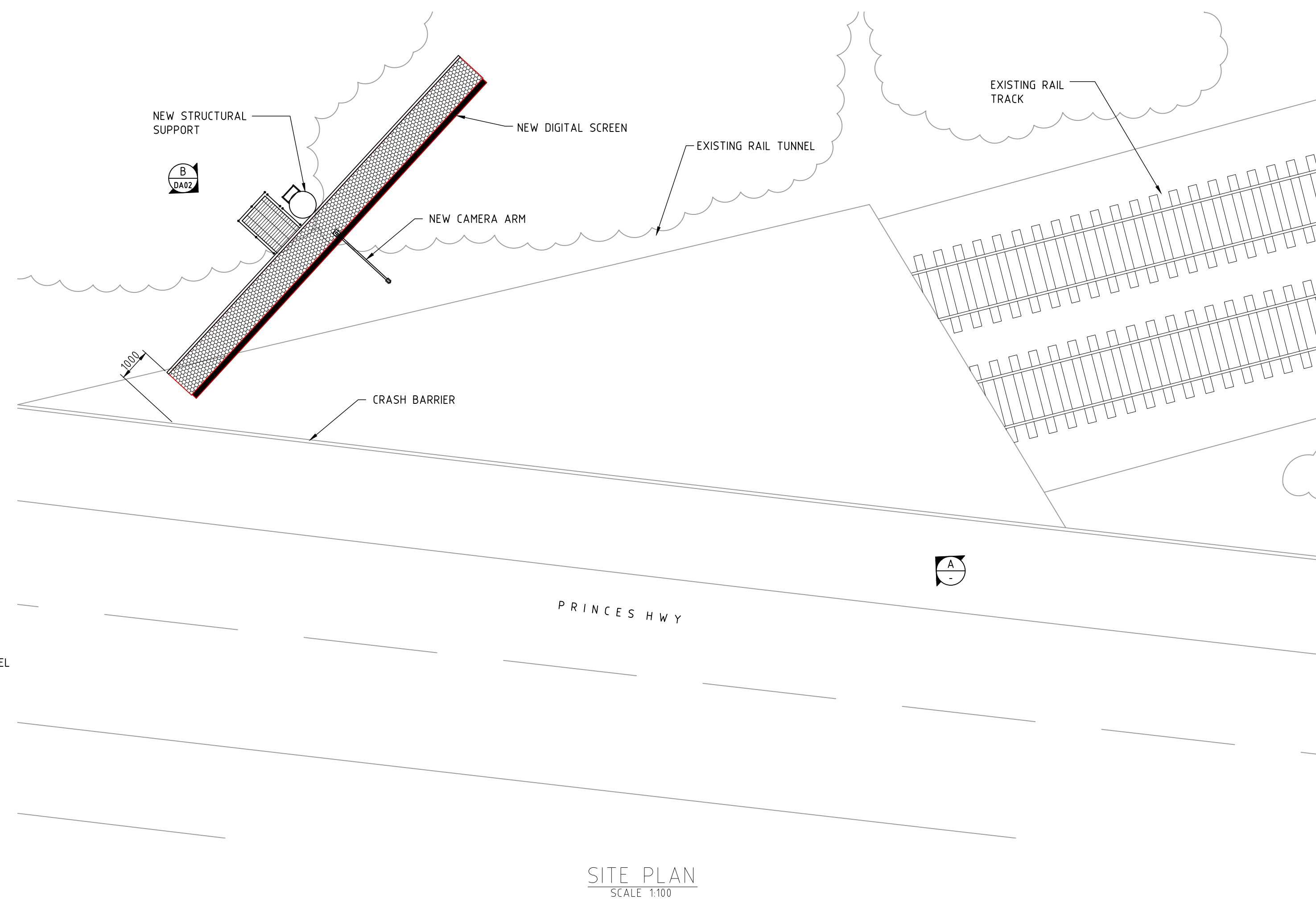

POLE AND ANCILLARY  
SUPPORTING STRUCTURE WILL BE  
PAINTED PALE EUCALYPT  
COLORBOND GREEN



ISS	DATE	COMMENT
A	09/12/21	ISSUED FOR APPROVAL
B	11/01/22	ISSUED FOR APPROVAL

Suite 1, Building 8, 49 Frenchs Forest Road East.  
Frenchs Forest, NSW 2086  
P.O. Box 652, Forestville, NSW 2087  
Ph: 02 9451 3455 Fax: 02 9451 3466  
Email: [info@dbce.com.au](mailto:info@dbce.com.au)  
ABN 23 039 013 724

st.	CLIENT: JCDecaux
	PROJECT: PRINCES HWY, LOFTUS, NSW, SUPERSITE

TITLE:  
PROPOSED DIGITAL SIGN  
GENERAL ARRANGEMENT &  
SITE PLAN

DRAWN A.T	DESIGN J.L	DATE: DEC 21
JOB NO: 21240		DWG NO: DA01
SCALE @ A1: AS SHOWN		REV: B

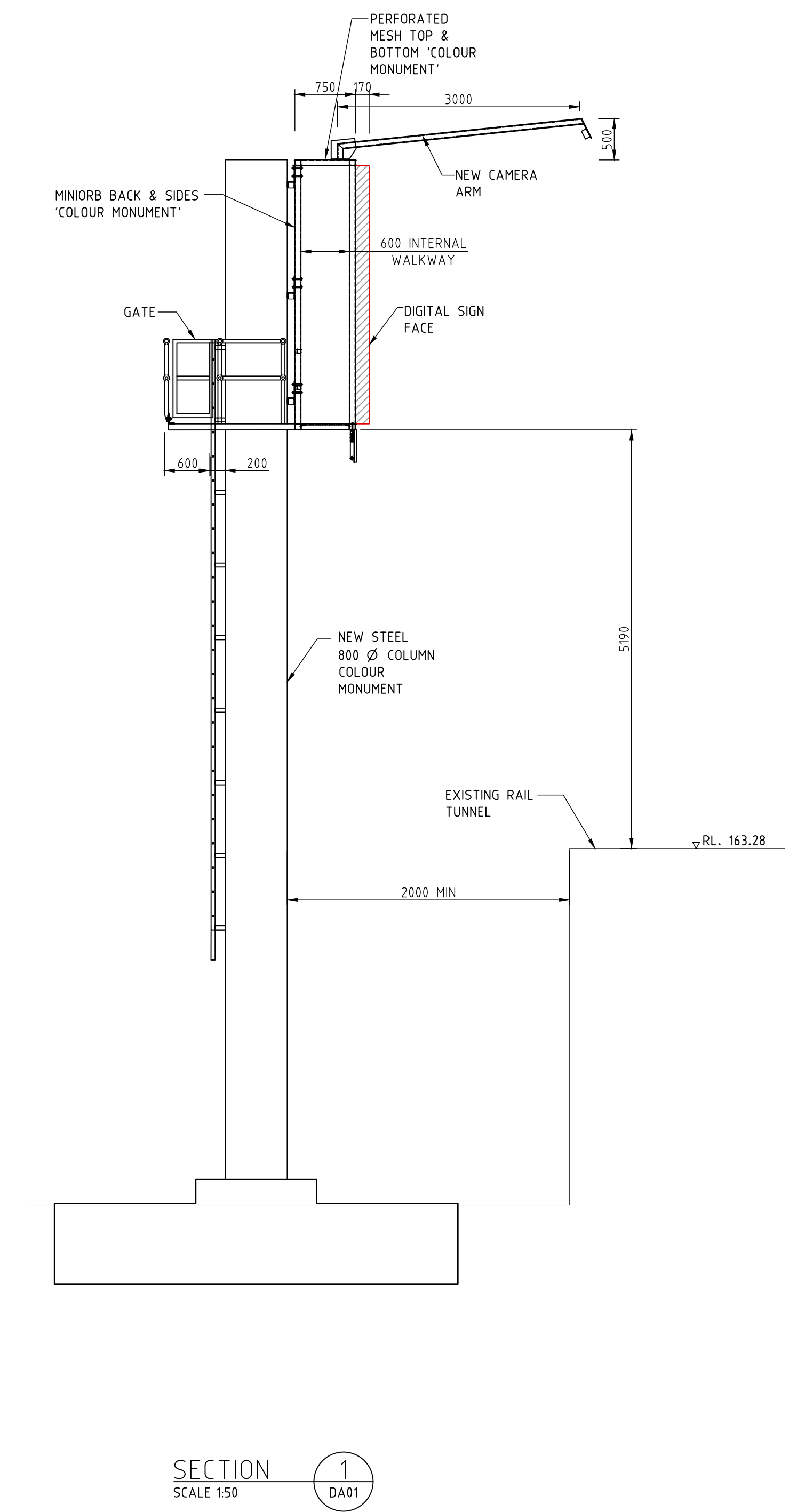
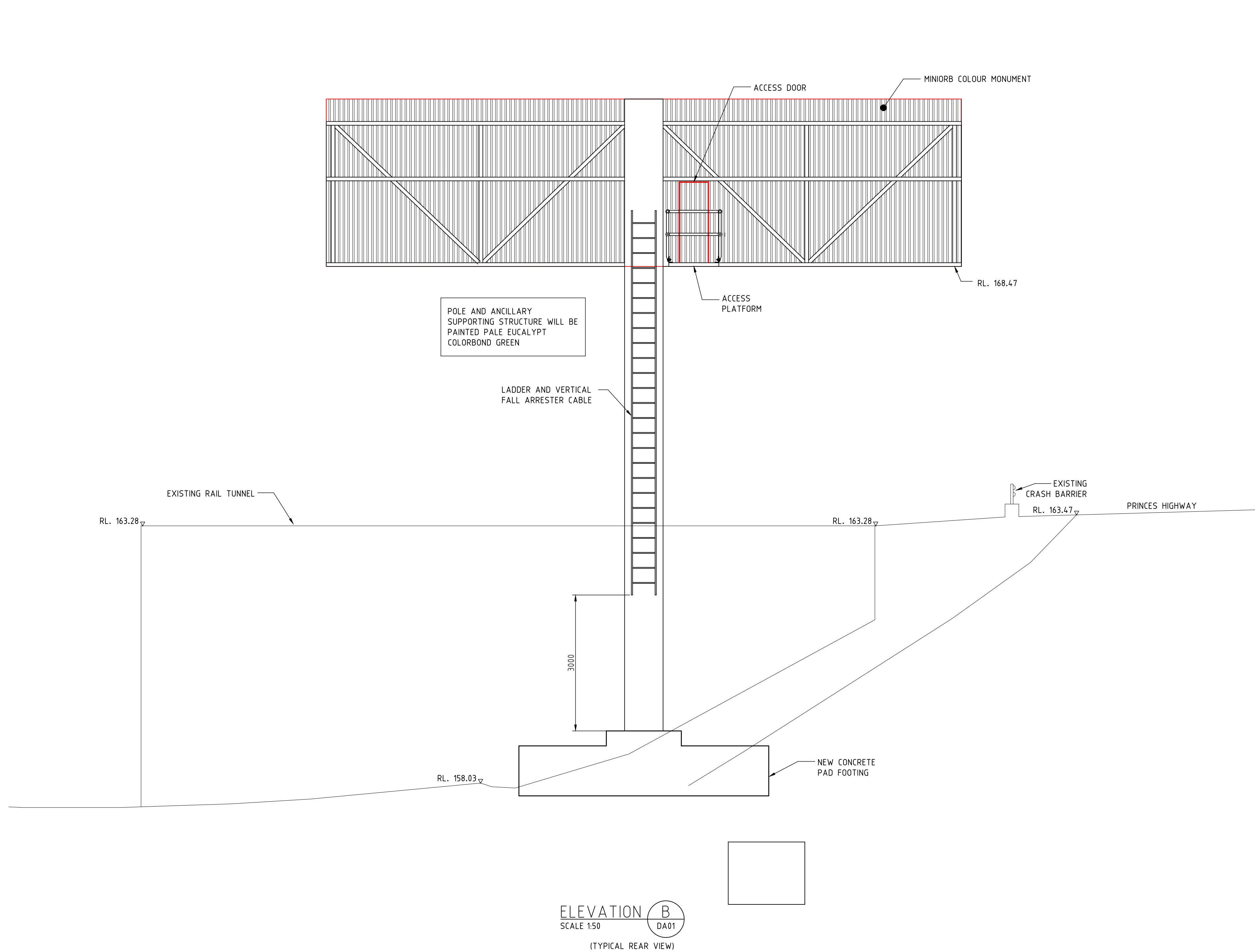

NOT FOR CONSTRUCTION

ISS	DATE	COMMENT
A	09/12/21	ISSUED FOR APPROVAL
B	11/01/22	ISSUED FOR APPROVAL



Suite 1, Building 8, 49 Frenchs Forest Road East,  
Frenchs Forest, NSW 2086  
P.O. Box 652, Forestville, NSW 2087  
Ph: 02 9451 3455 Fax: 02 9451 3466  
Email: info@dbce.com.au  
ABN 23 039 013 724

CLIENT:  
**JCDecaux**

PROJECT:  
PRINCES HWY, LOFTUS, NSW, SUPERSITE

TITLE:  
**PROPOSED DIGITAL SIGN  
GENERAL ARRANGEMENT &  
SITE PLAN**

DRAWN A.T	DESIGN J.L	DATE:	DEC 21
JOB NO:	21240	DWG NO:	DA02
SCALE @ A1: AS SHOWN		REV: B	